



GARCIA
y a c h t s

Garcia Exploration 45



General Description - Standard version

2 Cabins / 2 Heads compartments / 1 sea bunk

I. Key specification

A boat designed to sail and live aboard both in high latitudes and tropical waters

- ✓ Integral aluminium centreboard
- ✓ Deck salon with 270° visibility and internal steering position
- ✓ Watertight companionway door
- ✓ Protected watch position in forward part of the cockpit, with forward view
- ✓ Watertight forward aluminium bulkhead
- ✓ Watertight aft aluminium bulkhead with watertight hatches to access the stern compartments from the aft cabins
- ✓ All through-hull fittings made of welded aluminium - all valves positioned above waterline
- ✓ Double glazed salon windows, one opening above the galley - coachroof extends beyond the windows to act as a sun-awning
- ✓ Thermal and acoustic insulation above waterline using automotive-grade polyethylene foam panels
- ✓ Insulated floor (thick foam core)
- ✓ Chain locker centrally positioned at the foot of the mast – electric windlass located in locker below deck just forward of the mast
- ✓ Centrally located large capacity tanks - water and fuel tanks can be ballasted port/starboard
- ✓ Centrally located service battery set
- ✓ Generous stowage space available throughout the boat
- ✓ Forefoot chainplate for towing and ice breaking
- ✓ Integrated aft arch for electronics, wind generator, solar panels and use as davits
- ✓ Double steering system, twin aluminium rudder configuration JEFA self-aligning bearings to ensure optimal control in heavy seas, protective skegs and sacrificial end-fitting
- ✓ Large aft platform with easy access to/from the water
- ✓ Life raft stowage in locker accessed from aft platform
- ✓ All essential lines controlled from the cockpit

II. Construction features

Hull, deck and coachroof construction

- Hull, deck and coachroof structure in marine aluminium alloy
- 5083 H111 for aluminium structure and sheets
- 6060 T6 for extruded profiles
- Interior and exterior welding: MIG and TIG in inert (argon) gas
- Hull welding quality controlled by dye penetrant inspection
- Chainplates and reinforcement plates directly welded onto hull and deck structure
- Watertight forward and aft bulkheads directly welded onto hull and deck structure
- Built-in large capacity twin fuel tanks

Coachroof structure

- Vacuum infusion composite construction (fibreglass, PVC high density foam, polyester resin)
- Interface with deck and roof structure through gluing and bolting

Ballast and appendices

- Fixed, centrally positioned and resin-insulated ballast sited in keel skeg and lower compartments
- Fully retractable aluminium centreboard with NACA-type composite profile
- 2 NACA-type profiled aluminium rudders with protective skeg welded to the hull and sacrificial end-fitting

Insulation

- Thermal and acoustic insulation above the waterline by automotive grade polyethylene foam (thickness 74 mm for the hull and 37 mm for the deck)
- Thick foam core insulated floors

Coating and painting

- Deck and cockpit floor : comprehensive treatment consisting of a first coat of two-component epoxy primer, undercoats of two-component epoxy finish primer and coats of two-component polyurethane topcoat in Oyster White, and non-skid finish in all necessary areas
- Cockpit benches and helm seats: Flexiteek covered
- Hull topsides: Finish with adhesive acrylique covering. Matt color

Options

- *Flexiteek finish on sidedecks, cockpit floor and transom*
- *Marinedeck finishing on cockpit benches and helm seats*
- *Marinedeck finishing on side decks, cockpit floor and transom*
- *Lower hull preparation and anti-fouling (included in Marina preparation and delivery option in Cherbourg)*

Cathodic protection

- 2 fixed sacrificial anodes on keel skeg
- 1 sacrificial anode on centreboard
- 1 sacrificial anode on propeller

III. Rigging and sails

Mast and boom

- Aluminium alloy anodised double spreader mast
- Mast foot with turning blocks
- Wind vane, Led navigation and mooring lights at mast head, steaming light, Led anchor light and deck light
- Aluminium alloy anodised boom
- Boom vang
- 1 retractable mast step at the foot of the mast and 2 at the top

Options

- *Retractable mast steps along the mast*

Standing rigging and furling system

- Single strand stainless steel wire
- Furling system for Solent jib
- Fixed inner forestay (if no stay sail)

Options

- *Backstay with isolation for SSB*

Running rigging

- 1 Reeved mainsail halyard (polyester/dyneema mix)
- 1 Solent halyard polyester
- 2 Mainsail sheets polyester (twin "German sheeting mechanism")
- 1 Mainsail outhaul line (polyester/dyneema mix)
- 1 boom topping lift (12mm polyester used as *emergency mainsail halyard*) with *blocker at the foot of the mast*
- 3 polyester reefing lines , automatic for reef1 and reef2, semi-automatic for reef3
- 2 Solent polyester sheets
- 1 centreboard lifting line polyester
- 1 centreboard lowering line polyester

Sails

- 1 x 50 m² Dacron cross-cut mainsail with 4 reefs (4th reefing line not included)
- 1 x 41 m² furling Dacron cross-cut Solent

Options

- *Pack including fully-battened mainsail with ball bearing mast slider system, anti-chaffing patch, lazy bag Sunbrella made with "Exploration 45" labelling, adjustable lazy jacks and rigid boom vang*
- *Staysail with furling system and running backstays (staysail stay replacing the fixed forestay)*
- *Fittings for downwind sails (symmetrical/asymmetrical spinnaker, gennaker, code zero) - detailed in appendix*
- *Gennaker (90m2) / code zero (67m2) with furling system and custom banana-type bag*
- *Symmetrical / asymmetrical spinnaker*
- *Dousing sock for spinnaker*
- *Aluminium or carbon spinnaker pole with fittings and storage along the mast (detailed in appendix)*
- *Upgrade sailcloth from Dacron to Hydranet triradial cut (mainsail, solent, staysail)*
- *Custom labelling on lazy-bag*
- *Custom logo on spinnaker*

IV. External fittings

Windows, hatches, portholes and deck fillers

- Double glazed 270° forward windows with 1 opening above galley
- 1 Lewmar custom deck hatch (sail locker)
- 1 Lewmar deck hatch size 44 (forward cabin)
- 2 Lewmar deck hatches size 44 (coach roof deck salon)
- 2 Lewmar deck hatches size 03 (forward toilet/heads compartment and passageway)
- 4 Lewmar portlights size 3 (1 each cockpit side, 1 aft head and 1 aft port cabin)
- 8 fixed rectangular hull portholes (4 forward cabin, 2 aft cabin, 2 technical area), with recessed frames
- 2 fresh water deck fillers
- 2 diesel fuel deck fillers with anti-spill device
- 2 black water deck outlets

Options

- *2 additional hatches on coachroof above watch positions in the cockpit*
- *Plexiglas screens for additional insulation of cabin portholes*

Sailing hardware

- 2 Solent sheet deck curved tracks with double lead block (Solent and staysail)
- 2 Genoa sheet turning blocks with double clutches (Solent and staysail)
- 2 ST50 self-tailing 2 speed primary winches located on cockpit coamings
- 2 ST45 self-tailing 2 speed secondary winches located on cockpit coamings
- 1 ST40 self-tailing 2 speed mast winch on plate
- 3 Lewmar One-Touch locking winch handles with storage sleeve
- 8 Lewmar or equivalent jammers
- 1 jam cleat to lock the centreboard in the down position
- 1 blocker for Solent furling line

Options

- *Electric winches*
- *Winch size increase*
- *Additional mast winch*

Mooring and anchoring

- Bow roller for main anchor
- 1500W electric vertical windlass located below deck in locker at the foot of the mast, controlled at the foot of the mast
- Chain locker centrally positioned at the foot of the mast, with access from forward toilet compartment and watertight hatch
- Stern roller for secondary anchor
- 8 aluminium 330 mm mooring cleats welded onto deck
- 2 aluminium 160 mm mooring cleats on each side of the arch
- 1 double fairlead at the bow

Options

- *Radio controlled windlass*
- *Anchoring pack (detailed in appendices)*
- *Mooring pack (detailed in appendices)*
- *Electric LEWMAR capstan*
- *Chain rinsing pump in sail locker*
- *2 x 100m 12 mm floating lines fitted on winch drum incorporated in transom locker*
- *Removable furler with 70 m 4T strap line to be fixed to pushpits or granny bars*
- *Additional stern mooring cleats (pair)*
- *Aluminium handrails welded onto transom (pair)*
- *Tackle with strops for tender lifting*
- *Rigid davit on arch, with tackle and strops, for tender lifting*

Safety and protection

- Self-draining cockpit
- 2 pushpits, 2 pulpits, 10 stanchions in 316L stainless steel
- Led navigation lights (on pushpits, on transom, at mast head)
- 4 cockpit handrails
- 5 safety harness eyes in the cockpit
- 4 handrails on each side of the coachroof
- 2 boarding gates for port and starboard side access
- Lifelines made of uncoated single strand stainless steel wire with fixed fork end and snap hooks
- Welded aluminium toerail covered with Flexiteek (synthetic teak) and chain plates

Options

- *Granny bars*
- *Safety and emergency Premium pack for 6 or 8 people (detailed in appendices)*
- *Stainless steel fence*
- *Welded aluminium perforated toerail*

Deck hardware and stowage

- Integrated aft arch for electronics, wind generator, solar panels and use as davits
- Swimming ladder and hot water shower on aft platform
- Life raft stowage in locker accessed from aft platform
- Large, deep bow sail locker with ladder and floor
- 1 port cockpit bench locker, 2 helm seat lockers, 4 transom lockers including 2 for 13kg gas tanks
- 1 Stainless steel flagpole
- 1 Multifunction bracket welded at stern, with his aluminium plate
- 1 bracket for outboard engine

Options

- *Teak cockpit table with folding top, fiddle and cupholders, sunbrella cover*
- *External lights on watch positions, boom, spreaders, arch*
- *External upholstery made with Silvertex fabric*
- *Bimini,*
- *Canvas cover around cockpit, with mosquito screens*
- *Textile protection for watch position*

V. Interior fittings

General characteristics

- Woodwork in solid timber, marine ply, and white laminate (heads compartments)
- Main bulkheads and furniture in plywood with veneer
- Clear oak ambience
- Furniture base flaps in marine ply
- Heads compartments in white laminate
- 40 mm foam core insulated floors with laminate cover
- Multiple floor openings to ease access to lower compartments and technical components
- 8 mm marine ply head linings covered in washable Silvertex type fabric
- Marine quality hardware
- Dimable lightning
- Indirect lighting and lighting under steps
- Door retainers on all communication doors
- Upholstery in 130 mm thick highly resilient 40 kg/m³ foam with removable washable fabric cover from Trojan colour chart
- Mattress in 100 mm thick highly resilient 38 kg/m³ foam with removable Cool plus cover

Options

- *Afrormosia ambience, instead of clear oak*
- *Saloon leather or microfibre or Silvertex upholstery from colour chart*
- *Floor openings locking mechanism*

Companion way

- Watertight 2-leaf glazed door with aluminium frame and 4 locking points
- 2 curved bond laminated wooden steps with non-slip tape
- Handrails and lighting

Deck Saloon

- Located in the central/starboard part of the boat on an elevated platform with 270° panoramic view
- 1 U-shaped bench to starboard, with seats, backrests, large storage area under bench; can be converted into seaberths when on watch
- 1 central bench with large storage area beneath accessible from the galley
- 1 fixed central and folding table with fiddles
- Wooden shelf and storage lockers along the hull
- 4 led overhead spotlights and 2 reading lights

Options

- *Height adjustable central table support and additional cushions for double berth conversion*
- *Internal blinds for side saloon double glazed windows*

Pilothouse/chart table area

- 1 forward facing chart table with panoramic view
- Control panels for Instruments
- Hammock for resting when heeling
- Storage area under chart table
- Red/white LED spots at the chart table
- 2 x 12V / USB and 1 x 220V sockets

Galley

- Kitchen unit located to port along the hull
- 2 stainless steel sinks integrated into synthetic resin worktop with pressurised hot and cold mixer tap
- Seawater foot pump
- Double glazed stainless steel oven and 2 burner electronic ignition gas stove on gimbals with fiddles
- 1 gas shut-off valve
- 1 stainless steel 144 litre vertical 2-drawer refrigerator unit – with worktop above
- 1 vertical storage unit with drawers – with worktop above
- Ventilated storage (organised in removable boxes) and double waste bin under sinks
- Additional storage along the hull and under gas stove
- 1 large 4-drawer storage unit under central bench
- 1 stainless steel handrail
- Strip Led
- 1 x 220V socket
- 1 dorade vent
- 1 Extracting ventilation dorade
- 1 x butane bottle (13kg) in outside gas locker

Options

- *Electric gas shut off valve*
- *Fresh water/sea water foot pump with 3 way-valve*
- *220 V Microwave*
- *Upgrade gas stove to GN Espace Levante 2 burners an GN Espace sinks*

Forward passageway

- Located to port between galley and forward cabin
- Large storage lockers and lighting
- Sea bunk

Forward cabin

- 2 large horizontal non-opening hull portholes on each side and 1 hatch
- 1 central double bed with mattress and slatted base
- Large ventilated storage space under the bed
- Wooden shelves on each side along the hull
- 2 bedside steps on either side

- 1 cabinet with shelves and drawers to port
- 1 hanging locker to starboard
- 2 articulated bedside reading lamps
- 4 led overhead spotlights
- 1x 220V socket and 1x 12V/USB socket
- 1 dorade vent
- 1 Extracting ventilation dorade
- Ensuite heads compartment

Options

- *Cabinets for additional storage above bed*

Forward toilet/heads compartment

- Access via forward cabin, one hatch
- 1 vanity unit with synthetic resin worktop, mixer tap and storage
- 1 marine toilet
- 1 black water tank
- 1 mirror
- 2 led overhead spotlights
- 1 dorade vent
- 1 Extracting ventilation dorade

Options

- *1 shower unit with 12V evacuation pump*
- *Large dressing area with hanging storage, drawers and shelves instead of heads compartment*

Port aft cabin

- Located aft to port with 2 large non-opening portholes on the hull, 1 portlight opening to the cockpit and 1 portlight opening to the port coaming
- 1 double bed with mattress and slatted base, ventilated under bed storage with access from the front of the bed
- 1 hanging locker with shelves
- Wooden shelf along the hull
- Removable panels/doors for access to the central technical area
- 1 watertight hatch on the aft bulkhead to access the stern compartment (steering mechanism)
- 2 articulated bedside reading lamps
- 1 led overhead spotlight
- 1x 12V/USB socket
- 1 dorade vent
- 1 Extracting ventilation dorade

Starboard aft toilet/heads compartment

- 1 opening portlight
- 1 vanity unit with synthetic resin worktop, mixer tap and storage
- 1 shower unit with 12V evacuation pump
- 1 marine toilet
- 1 black water tank

- 1 mirror
- 1 led overhead spotlight
- 1 dorade vent
- 1 Extracting ventilation dorade

Options

- *Large aft toilet/heads compartment with separate shower (Comfort version)*
- *Electric toilet (if separate shower)*

Starboard aft technical locker/utility area

- 2 large non-opening horizontal portholes in the hull and 1 opening portlight in the cockpit
- 1 workbench with openings for storage
- 1 large central storage/technical area
- 1 watertight hatch on the aft bulkhead to access the stern compartment (steering mechanism)
- 1 led overhead spotlight and 1 moveable neon light
- 1 x 220V socket
- 1 x 12V/USB socket

Options

- *Aft technical locker converted into a twin bunk aft cabin with central technical area*
- *Supply and installation of Integrated storage boxes under workbench*

VI. Systems

Motorisation

- Volvo Penta D2-75 diesel engine mounted on flexible engine mounts
- Reduction/reverse gearbox, ratio 2.74 / 1
- Fuel pre-filter
- Engine compartment acoustic insulation by visco-elastic mass absorbing foam
- Twin pole engine insulation
- Aluminium stern tube
- Stainless steel propeller shaft and shaft seal
- 3 blade 21" fixed propeller
- Cooling via sea water intake with quarter turn stopcock and filter
- Forced air ventilation
- Engine instrument panel with alarms
- 2x350 litres fuel tanks with individual fillers, vents and 12V transfer pump for ballasting

Options

- *Three-blade auto-feathering propeller instead of fixed propeller*
- *Electrical engine control and additional engine control in pilothouse*
- *Rope cutter*
- *Dual fuel filters with changeover valve*
- *Algae-X fuel conditioning system*
- *Fuel polishing Racor system*
- *Additional 250 litres fuel tank*

Rudder and steering gear

- 2 leather-covered cockpit steering wheels with sunbrella cover, each fitted on an independent JEFA cable steering system, linked to each other by removable mechanism
- 2 NACA-type profiled rudders mounted on self-aligning JEFA roller bearings directly welded to the hull structure
- 2 solid aluminium rudder stocks
- 2 protective skegs welded directly onto the hull

Ventilation

- Natural ventilation via multiple hatches, portholes and air vents under protected areas
- 4 aluminum dorade boxes that can be closed from the inside (1 located in the forward heads compartment, 1 in passageway, 2 in deck saloon)
- 3 electrical ventilation units for air extraction

Electricity

- 1 diesel engine coupled 12V/115A alternator
- 1 x 220 V shore power socket with 25 metre cable
- 1 x 110/220V /3600W isolation transformer with auto switch 110/220V and 50/60Hz on on-

board sockets

- 2 x 220 V multifunction electric panels with 2-pole circuit breakers
- 1 x 12V multifunction electric panel with 2-pole circuit breakers, electrical leak detector, navigation lights control panel, bilge pump alarms and control panels, ballast pumps control panel, voltmeter, water and fuel gauges
- 1 x 220V / 12V / 30A battery charger
- 3 x 12V/108Ah Lead-Calcium batteries (1 for engine/2 for services)with bipolar cut-off switches
- 1 load balancer with 2 lines
- 4 x 220V outlets (forward cabin, galley, chart table and aft technical locker)
- 6 x 12V/USB outlets (2 chart table, 1 technical locker, 1 cockpit, 1 each front and aft cabin)

Options

- *International electricity Pack (detailed in appendices)*
- *Touchscreen tank and batteries monitoring system with charging systems monitoring*
- *Additional 108Ah Lead-Calcium service batteries with box (pair)*
- *Upgrade for gel service batteries or lithium service batteries instead of lead-calcium batteries*
- *Generator (detailed in appendix)*
- *Additional charging equipment : hydro generator, solar panels, ... (detailed in appendices)*
- *Sterling Power alternator-to-battery charger (battery set charging optimiser)*
- *Additional 220V or 12V/USB sockets (inside/outside)*
- *2 red/white LED light for night vision in galley and aft toilet/heads compartment*

Plumbing and pumping

Fresh water circuit

- 2x250 litres polyethylene fresh water tanks with individual fillers, vents, level gauges and transfer pump
- Pressurised water system with expansion tank
- 1 x 20 litre calorifier (Hot water from engine or 220V)
- Water distribution by manifold to allow for the isolation of each circuit
- 1 hot/cold water circuit to galley
- 1 hot/cold water circuit to forward heads compartment
- 1 hot/cold water circuit to aft heads compartment
- 1 cold water circuit to shower on aft platform

Options

- *Upgrade to 40 litre 3-energy source calorifier (220V, engine heat exchanger and from optional Webasto water based heating system)*
- *Additional hot water circuit to shower on aft platform*

Black and grey water circuits

- Grey water from galley sinks evacuated by gravity
- Grey water from toilet/heads compartment evacuated by 12V drainage pumps
- Black water from forward heads evacuated by manual pump to black water tank
- Black water from aft heads evacuated by manual pump to black water tank
- Black water tank emptied via deck outlet and by 12V drainage pump (aft tank) or gravity (front tank)

Options

- *Grey water tanks (if no diesel additional tank) : Grey water from sinks and heads evacuated to 250L grey water tank – grey water tank emptied via deck outlet or by 12V drainage pump*

Bilge pumps

- 1 x 12V primary electric bilge pump in the bilge compartment with alarm + controls
- 1 x 12V electric bilge pump in the sail locker
- 1 x 12V electric bilge pump in the forward compartment
- 1 x 12V electric bilge pump in the stern compartment
- 1 manual bilge pump in the cockpit
- 1 mobile manual pump

Fire protection

- 4 x mobile extinguishers
- 1 x anti –fire cover
- 1 x smoke detector

VII. Documentation and formalities

All necessary documents provided:

- Owner's manual including diagrams of all circuits
- Electric diagrams corresponding to the effective built
- Instructions, manufacturer technical instructions for the engine and the various equipment installed
- Equipment guarantees
- CE compliance certification documents

Administrative formalities for registration in Cherbourg (legal fees to be borne by owner)

VIII. Additional options

Preparation and delivery of the boat in the Cherbourg Marina, including

- Hull preparation and anti-fouling
- Craning and launching
- 100 litres of fuel
- Commissioning
- Tuition and handling (5 half-days)
- Availability of berth at Cherbourg Marina dock for 10 days

Fittings for downwind sails (gennaker / code zero, / asym spi / sym spi) including

- Chainplate on bow roller
- Constrictor jammer for tack of the sail, tackle hoist with halyard shackle, dyneema tackle rope
- Dyneema halyard with hollow pin deck block, block at mast foot to return to cockpit, jammer in the cockpit
- Polyester halyard with hollow pin deck block and jammer at foot of the mast
- Sheets, turning blocks, fabric loop to connect to aft chainplates
- Pair of barber haulers with hoists, blocks and cleats
- Fittings for furling line returning to the cockpit

Spinnaker Pole with storage, including

- Carbon or aluminium spinnaker pole with storage mechanism along the mast
- Spinnaker rail on mast with plug
- Spinnaker topping lift with block at the foot of the mast to return to cockpit
- Cleat at the foot of the mast and jammer in the cockpit
- Spinnaker downhaul with turning blocks and cam cleats on the cockpit coamings

Bow thruster

- Max Power or equivalent tunnel model with 100 kg thrust, with 2 AGM 12V/55Ah batteries, dedicated charger, and battery switches

On-board comfort

- Blinds and mosquito nets on hatches
- Blinds for portlights in cabins
- Lee cloths or lee boards
- Compact 220 V washing machine (requires generator for hot water washing while at sea)
- 12V or duo 12V/220V, 60 or 100 litres per hour Dessalator watermaker
- Vitrifrigo 70 liters 12 V Sea Drawer freezer (in forward passage way)
- Key lock safe

Energy

- 12V Watt&Sea hydro generator with regulator and storage position in sail locker
- 12V Silentwind wind generator including support and load controller
- 12V 520W solar panels fitted on aft arch including MPPT load controller

- International electricity Pack allowing to plug into 110/220V - 50/60 Htz shore power, including :
 - 2x additional 108A 12V Lead-Calcium service batteries
 - Upgrade 12V battery charger from 30 to 60 A
 - 1x 12V/220V/2000W sinusoidal converter
 - 1x 220V shore power / converter switch

- 4KW Generator Pack (complement and substitutes the International Electricity Pack) including :
 - 1x 220V Fischer Panda 5000 I Neo generator
 - 2x additional 108A 12V Lead-Calcium service batteries
 - 1x 12V/220V/2000W sinusoidal converter
 - Upgrade 12V battery charger from 30 to 60 A
 - 1x commutateur 220V quai / convertisseur

- 6.4KW Generator Pack (complement and substitutes the International Electricity Pack) including :
 - 1x 220V Fischer Panda 8000i generator
 - 1x starting 108Ah-12V
 - 2x additional 108A 12V Lead-Calcium service batteries
 - 1x 12V/220V/2000W sinusoidal converter
 - Upgrade 12V battery charger from 30 to 60 A
 - 1x commutateur 220V quai / convertisseur

Electronics

- B&G 8" electronic pack including:
 - 1x 8" Zeus³ touchscreen
 - 1x NAC3 autopilot drive
 - 1x Precision9 compass
 - 1x JEFA power unit
 - 1x V50 VHF unit
 - 1 wind vane
 - 1 speed/depth/water temperature sensor
 - 3x Triton³ display units
 - 3x pilot control Triton
 - 1x NAIS 500 B&G Class B AIS transponder
 - 1x 4G B&G broadband radar

- B&G 12" electronic pack including:
 - 2x 12" Zeus³ touchscreens
 - 1x ZC² touchscreen control
 - 1x NAC3 autopilot drive
 - 1x Precision9 compass
 - 1x JEFA power unit
 - 1x VHF V50 unit with remote wireless handset H50
 - 1 wind vane
 - 1 speed/depth/water temperature sensor
 - 3x Triton³ display units
 - 2x Triton pilot controls
 - 1x AP44 pilot control
 - 1x WR10 wireless autopilot control unit
 - 1x PC / USB interface NMEA data
 - 1x GPS active antenna ZG100
 - 1x NAIS 500 B&G Class B AIS transponder
 - 1x 4G B&G broadband radar

- Spare autopilot NAC3 computer and power drive unit with switch
- Forward scan sensor

- Fusion Audio Marine Pack including:
 - 1 x MS-AV755 CD/DVD Marine Stereo or UD755 (dock station)
 - 1 x USB connection kit
 - 1 x MS-BT200 Bluetooth connection kit
 - 2 x MS-BX3020 100W 2-way built in high quality speakers
 - 2 x MS-FR602 200W 2-way waterproof cockpit speakers
 - 1 x Hifi/VHF switch

Communication

- SSB Icom 801, with Pactor Modem
- Iridium passive antenna on arch for iridium phones
- Iridium phone with his dock (Motorola 9575 Extrem)
- Iridium Go
- Iridium Pilot and phone
- Wifi/ 4G+ antenna + wifi amplification unit and access at the chart table

Air conditioning, ventilation and heating

- 12 V ventilators
- 1x 13K BTU A/C unit in the salon and 1x 8K BTU unit in the front cabin
- Fuel burning water heating Webasto or equivalent system with fans

Safety and security Premium pack (6 or 8 people)

- 1 x life raft Vicking Rescyu 8UKL Container Pack II ISO 6/8 persons
- 1 x grab-bag 24h - 6/8/10 Man
- 1 x Epirb distress radio Kannad GPS SafePro Manuel
- 6/8 x Spinlock Deckvest 5D Hammar lifejackets
- 6/8 x 3 hooks GIB safety lines
- 1 x foghorn
- 1 x Mob Boy Horseshoe Set
- 1 x safety mirror
- 1 x offshore flare pack
- 1 x offshore medical kit
- 1 x iris 50 hand bearing compass
- 1 x CRAS measuring rule
- 1 x COASTAL 17cm divider
- 2 x 10 litre plastic buckets with 1,5m line
- 1 x safety plugs pack
- 1 x set of 3 30x40 cm flags (NAT, C & N)
- 2 x 180 mm plastic flashlights
- 1 x black ball (at anchor) signal
- 1 x black cone signal
- 1 x 30 metre lead line
- 1 x safety blanket
- 1 x set of 3 spare compact navigation lights (battery operated)
- 2 x 10 m white jackstays
- 1 x rescue sling
- 1 x IOR device + light

Anchoring pack

- 1 x 25 kg Spade galvanized anchor with 1 x 100 m galvanized 10 mm chain with shackles and snubber line for bow anchor
- 1 FX37Fortress light anchor with 1 x 50 m nylon 16 mm warp of which 20 m metal weighted with shackles for aft anchor
- Other anchor models and sizes upon request

Mooring pack

- 6 performance 23 x 85 cm fenders with protective sleeves
- 4 x 10 metre 16 mm braided 3-strand hawsers,
- 2 x 15 metre 16 mm braided 3-strand hawsers
- 1 x hull protection cloth

Diving pack

- 220V Junior 2 Bauer compressor with accessories (requires generator)
- Storage for 2 diving tanks

Tender pack

- Foldable tender F-Rib 275 and Honda 8CV outboard engine

IX. Basic specification

Length overall	14.88	Metres	48.82	Feet
Hull length	14.21	Metres	46.62	Feet
Waterline length	12.57	Metres	41.24	Feet
Beam	4.44	Metres	14.57	Feet
Draught (centreboard down)	2.90	Metres	9.51	Feet
Draught (centreboard up)	1.14	Metres	3.74	Feet
Air draught (excl. Antenna)	19.80	Metres	64.96	Feet
Displacement	14 612	Kg	32 214	Lbs
Fixed ballast	4 540	Kg	10 009	Lbs
Diesel capacity	700	Litres	153	Imp Gallons
Water capacity	500	Litres	109	Imp Gallons
Black water capacity	110	Litres	24	Imp Gallons
Number of cabins	2-3		2-3	
Number of berths	4-6-8		4-6-8	

Architect/Designers

- Naval Architect: Berret-Racoupeau Yacht Design
- Designer: Berret-Racoupeau Yacht Design

Construction

- Built in France by Garcia Yachting SAS

Certification

- Category A CE certification

Layouts

Standard Version



Comfort Version

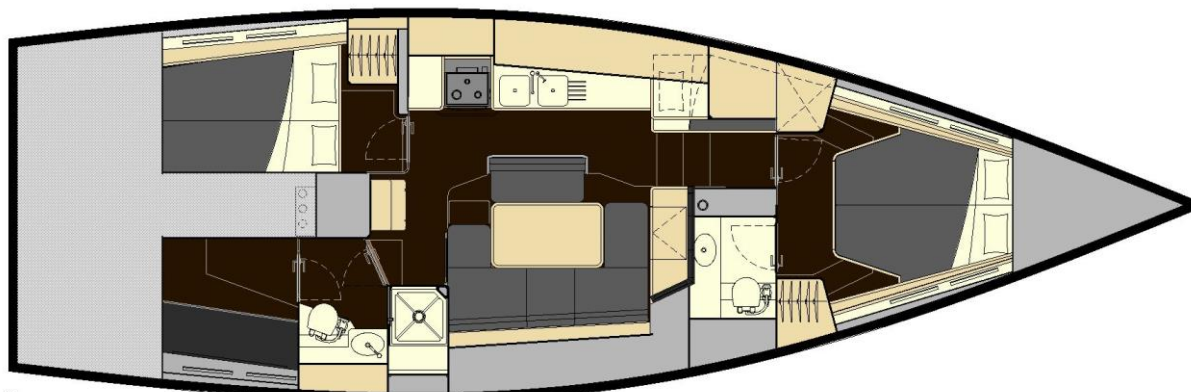

Main views

Profile

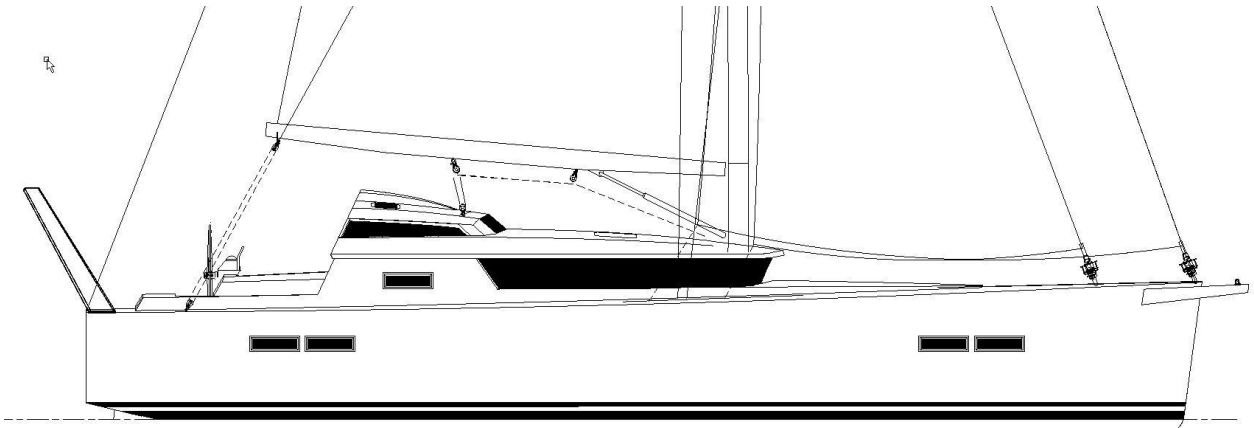

Axial cut



Sail plan

